

GCDF Series

● Dimensions and Land Patterns. (UNIT: mm)

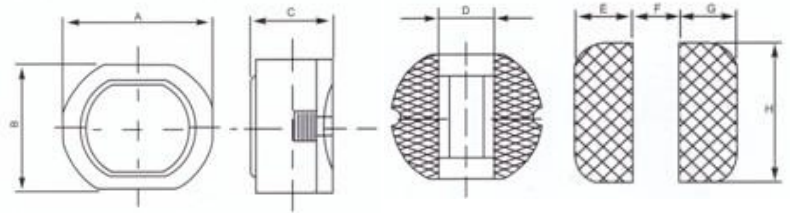

● Applications:

Notebook, Desktop, Modem equipment
LCD,OA equipment other electronic equipment

● Operating temperature: -40 °C to +125 °C

TYPE	A	B	C (max)	D	E	F	G	H
GCDF62B	6.2±0.30	5.6±0.30	3.50	2.20	2.40	1.80	2.40	6.00
GCDF75B	7.8±0.30	7.0±0.30	4.80	2.50	3.50	2.00	3.50	7.50
GCDF105B	10.0±0.40	9.0±0.30	5.50	3.20	4.50	2.50	4.50	9.50

● Part Numbering

GCDF 75B M T 100

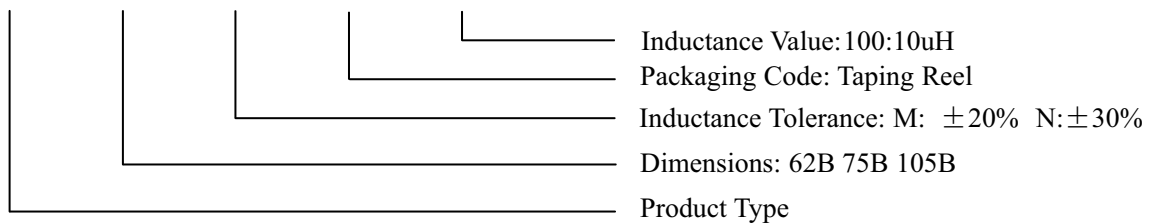

Electrical characteristics List

GCDF62B/75B/105B Series

PART No.	L (uH)	Tolerance	Test Condition	DCR (Ω)MAX			IDC (A)		
				62B	75B	105B	62B	75B	105B
GCDF◇◇NT1R2	1.2	N	100KHZ/0.25V	0.008	0.010	0.006	2.80	4.300	5.50
GCDF◇◇NT1R5	1.5	N	100KHZ/0.25V	0.013	0.012	0.007	2.50	3.700	4.90
GCDF◇◇NT1R8	1.8	N	100KHZ/0.25V	0.019	0.014	0.008	2.35	3.100	4.20
GCDF◇◇NT2R7	2.7	N	100KHZ/0.25V	0.026	0.014	0.011	2.00	2.700	3.70
GCDF◇◇NT3R9	3.9	N	100KHZ/0.25V	0.031	0.018	0.013	1.55	2.600	3.00
GCDF◇◇NT5R6	5.6	N	100KHZ/0.25V	0.039	0.021	0.016	1.35	2.250	2.70
GCDF◇◇NT6R8	6.8	N	100KHZ/0.25V	0.044	0.030	0.018	1.25	2.000	2.30
GCDF◇◇MT100	10	M	1KHZ/0.25V	0.060	0.039	0.022	1.18	1.800	2.00
GCDF◇◇MT150	15	M	1KHZ/0.25V	0.094	0.060	0.034	0.90	1.570	1.70
GCDF◇◇MT220	22	M	1KHZ/0.25V	0.130	0.075	0.043	0.72	1.230	1.40
GCDF◇◇MT330	33	M	1KHZ/0.25V	0.176	0.109	0.061	0.63	1.000	1.15
GCDF◇◇MT470	47	M	1KHZ/0.25V	0.260	0.150	0.092	0.49	0.810	0.94
GCDF◇◇MT680	68	M	1KHZ/0.25V	0.426	0.241	0.120	0.42	0.660	0.79
GCDF◇◇MT101	100	M	1KHZ/0.25V	0.520	0.312	0.182	0.34	0.585	0.66
GCDF◇◇MT151	150	M	1KHZ/0.25V	1.000	0.403	0.302	0.30	0.420	0.50
GCDF◇◇MT221	220	M	1KHZ/0.25V	1.220	0.650	0.384	0.24	0.350	0.45
GCDF◇◇MT331	330	M	1KHZ/0.25V	2.020	1.050	0.0559	0.20	0.300	0.36
GCDF◇◇MT471	470	M	1KHZ/0.25V	2.540	1.300	0.780	0.16	0.260	0.30
GCDF◇◇MT681	680	M	1KHZ/0.25V	3.740	2.340	1.070	0.14	0.210	0.24
GCDF◇◇MT102	1000	M	1KHZ/0.25V	5.720	3.120	1.590	0.11	0.170	0.20